

EVENT SPACES AND EXPERIENCES

MUSEO PICASSO MÁLAGA



museo**PICASSO**málaga



THE MUSEUM

In answer to Pablo Ruiz Picasso's wish for a place in his native city where his work could be shown to society, the Museo Picasso Málaga was inaugurated in 2003. The institution has since then become fundamental for an understanding of the rich development of local culture. The museum is both a landmark and a magnet, as well as a key symbolic referent for anyone living in the capital of the Costa del Sol. For those drawn to Málaga from all parts of the world by the talent and fame of the most important painter of the 20th century, it is moreover an invitation to learn at close hand about the life and work of the locally born artist.

A visit is made all the more attractive by the architectural merits of the Palacio de Buenavista, the building that houses the Foundation, whose vernacular heritage has not only been respectfully restored but also intelligently combined with contemporary architecture.

Located in the city's historic heart, very near the Cathedral and the Roman Theatre, it shows temporary exhibitions and organises a variety of educational and cultural programmes. The permanent Collection, devoted in its entirety to Picasso's work, comprises more than 230 paintings, sculptures, drawings, graphic works, and ceramics created between 1892 and 1972. They embody the groundbreaking innovations that mark the artist's career and the wide range of styles, materials and techniques he revolutionised.



EVENTS

The museum becomes an exclusive partner for your event in the capital of Costa del Sol

CONGRESS

WORK MEETING

CONVENTION

COCKTAIL AND DINNER

PRIVATE VISIT

ART WORKSHOP

TEAM BUILDING

FORUM

SYMPOSIUM



SPACES

An exquisite and versatile architecture in the city centre of Málaga

AUDITORIUM

BUENAVISTA PALACE'S MAIN COURTYARD

GARDEN

COVERED COURTYARD

ROOM XII

EDUCATIONAL ROOM

In 2006 the American Institute of Architects awarded the MPM the Institute's Honor Award for Architecture. The jury commented: "This is a beautiful job of restoration architecture... It is appropriately modest, weaving a museum into the fabric of this Mediterranean city. New portions were simply and elegantly inserted in and around the 16th century castle, the outdoor courtyards and the city streets."

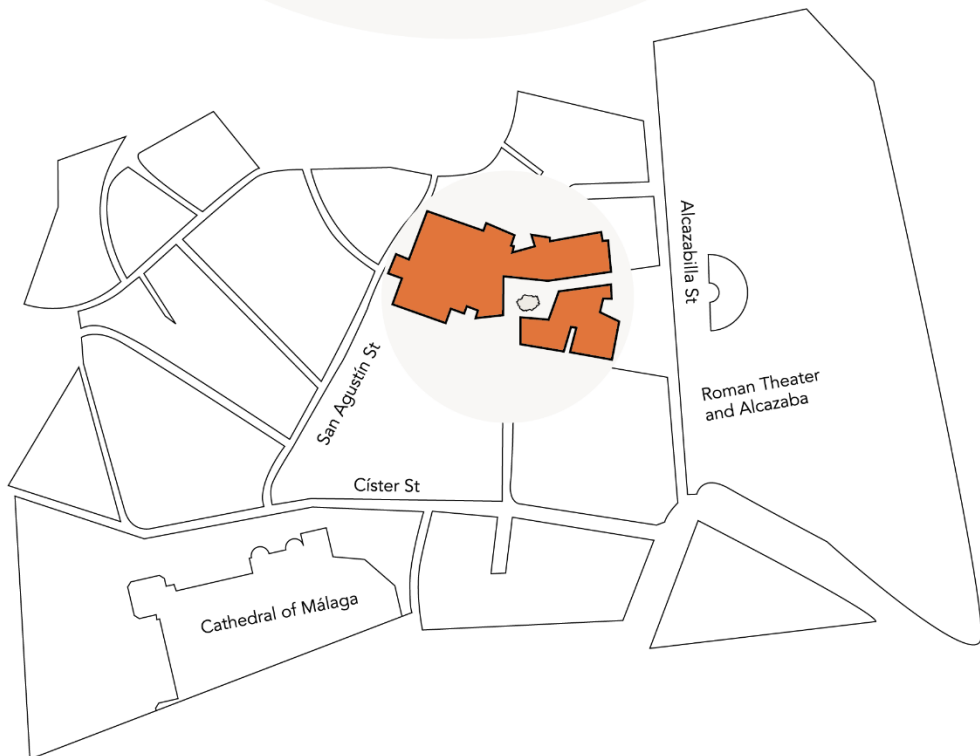



 [KNOW MORE](#)



AUDITORIUM

AVAILABILITY

Monday to Sunday.

TOTAL AREA

570 m.²

CAPACITY

172 seats arranged in 11 rows.

AUDITORIUM EQUIPMENT

- Stage machinery control systems and illumination such as the ones in theaters.
- Sound system Dolby Sound Round, screen projector 10.000 lumens 1920 x 1200 and big screen.
- Control cabin and 2 simultaneous interpretation and talks cabins. Network and management system BOSCH DCN for congresses in 3 languages.
- Entrance Hall: 2 plasma screens, cloakroom and ticket office.
- Dressing room with private access. 3 make-up stands, toilet and shower.
- Technical Support for live streaming broadcasts.

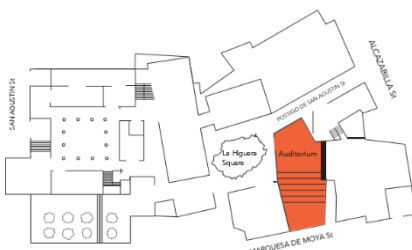



BUENAVISTA PALACE'S MAIN COURTYARD

AVAILABILITY

Monday to Sunday outside opening hours.

TOTAL AREA

260 m.²

CAPACITY

Cocktail: 150 guests per floor.

Dinner: 120 guests per floor.

The Palace's main courtyard is a magnificent example of 16th-century Andalusian architecture with its characteristic mixture of Renaissance and Mudejar elements.

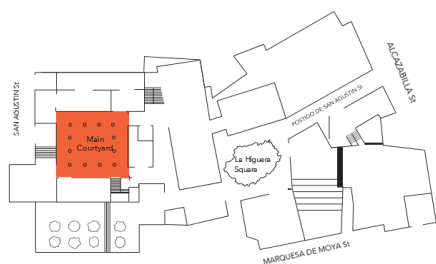

 [KNOW MORE](#)



GARDEN

AVAILABILITY

Monday to Sunday outside opening hours.

TOTAL AREA

300 m.²

CAPACITY

Cocktail: 150 guests.

Dinner: 60 guests.

Open air space that reminds us of the Mudejar style gardens. Surrounded by cypresses, orange trees, bougainvilleas, jasmines and geraniums, this space has an aura of tranquility and stillness.

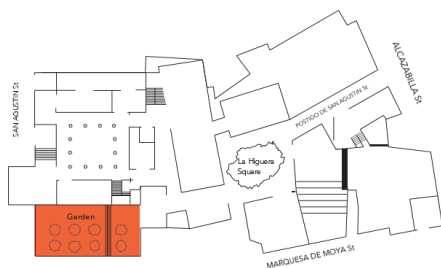

 [KNOW MORE](#)



COVERED COURTYARD

AVAILABILITY
Monday to Sunday outside opening hours.

TOTAL AREA
120 m.²

CAPACITY
Cocktail: 90 guests.
Dinner: 50 guests.

This space sets apart the galleries of the Collection and the galleries of the temporary exhibitions. It becomes an ideal place to witness the building's architecture and its transition.

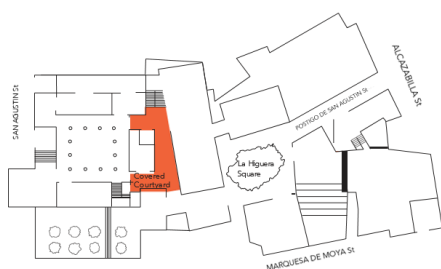

 [KNOW MORE](#)



ROOM XII

AVAILABILITY

Monday to Sunday outside opening hours.

TOTAL AREA

45 m.²

CAPACITY

20 guests standing.

15 guests seated.

The only exhibition room with Pablo Picasso's artworks destined to unique and exclusive professional meetings or special dinners.

 [KNOW MORE](#)



EDUCATIONAL ROOM

AVAILABILITY
Monday to Sunday.

TOTAL AREA
38 m.²

CAPACITY
25 guests seated.

Arranged as a classroom, this versatile space can be adjusted to your needs. Equipped with projector, screen and sound system.

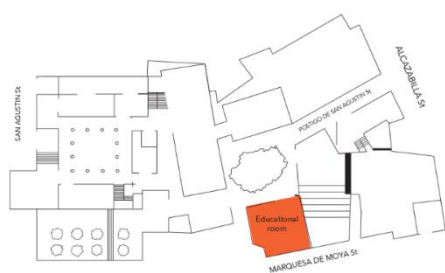

 [KNOW MORE](#)



EXPERIENCES

The MPM private tour programme offers you the chance to customize your museum experience. Designed for museum visits on unique occasions.

The tour is based on “Dialogues with Picasso. Collection 2020-2023”, which spans almost eight decades of work, conveying the skill and creative ability of this quintessential artist.

The temporary exhibition programme offers visitors different ways to approach Pablo Picasso’s art, discover his artistic milieu, and consider the scope of his work.

The visit is completed with a look at the architecture of the Buenavista Palace, which has been declared a National Monument, with an American Institute of Architects award-winning refurbishment project.

A creative experience, with art workshops devised by the museum’s educational and cultural activities department, might be the perfect complement to the visit.



PRIVATE VISITS

Accompanied by the museum's tour guides, discover the exhibition rooms or the architecture of the Buenavista Palace, in a very special way.

During opening hours. Accompanied by a guide, with exclusive access to the roof terraces and a limited-edition gift for each guest.

Outside opening hours. Before or after opening hours - the most personal and unique way. The museum spaces are open exclusively to guests, with all necessary services provided. Visit with a tour guide or with an audio guide service (available in 13 languages).

 [KNOW MORE](#)

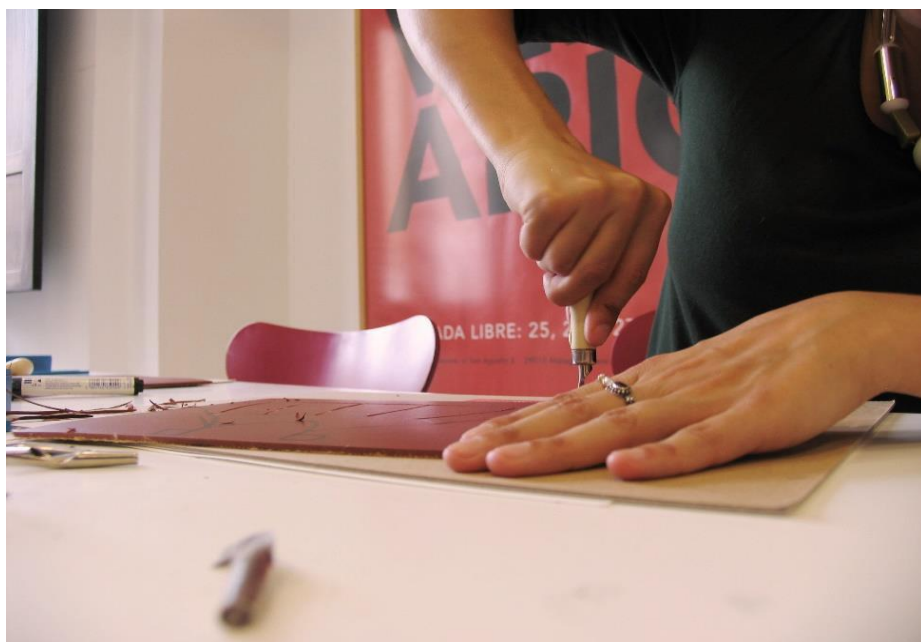

ART WORKSHOPS

The ideal follow-up. Experience artmaking at first hand, after your tour.

Meaningful ideas and emotions are expressed through art that cannot be mastered or conveyed by common language. Create art with some of the techniques with which Pablo Picasso worked, such as chalcography or linotype etching.

 [KNOW MORE](#)



TEAM BUILDING

More than Art. Artmaking Workshop for companies.

An activity for corporate professionals and managers. Take part in an exclusive customized workshop, set in the cultural and artistic environment of the museum.

In a relaxed, collaborative atmosphere, away from their working environment, they will take part in an etching workshop where they can explore one of the techniques employed by Picasso.

The artistic process becomes a tool that encourages dynamics that help to improve productivity, empathy, and teamwork, in a stimulating and creative way.

 [KNOW MORE](#)



INFORMATION

The museum is located in the heart of the City centre of Málaga, halfway between the Cathedral and La Merced square.

PARKING LOTS NEARBY

Alcazaba, Plaza de la Marina and Muelle 1.

BUSES

Buses can park temporarily next to the Málaga's City Hall Building.

OPENING HOURS

- 10.00a.m to 18.00p.m NOV - FEB.
- 10.00a.m to 19.00p.m MAR - JUN / SEP - OCT.
- 10.00a.m to 20.00p.m JUL - AUG.

ENQUIRIES

For further information on hiring a space at the museum adapted to your requirements:

✉ eventos@mpicassom.org

Palacio de Buenavista
San Agustín, 8
29015 Málaga
www.museopicassomalaga.org

museo**PICASSO**málaga